

IRIS Public Record**Key Information**

Main: GROUP/0416/BOMBARDMENT (LIGHT)

Document Type:

Call Number: **GP-416-SU-OP-S**IRIS Number: **00091982**

Accessions Notes:

Old Accession Nbr:

Title:

Beginning Date:

End Date:

Publication Date: **1944/12/10**Classification **UNCLAS**

Media Roll #: **0000001714** First Frame: **1275** Last Frame: **1336** Linear Feet: **0**
 Old MFlm Roll # **B0534** Audio Rec:

NUMPAGE **61**

Title Extensions:

Abstract CONTAINS TARGET DATA AND MISSION REPORT.Descriptive
Notes:**Title** MISSION NUMBER 168**Added****Entries****Author:****Subject:**

Major Command:

Administrative Markings

No Administrative Markings Listed

Security Review Information:

Rcvd:	Rel	1985/03/05
Indexer ID: 24	Entered Date:	
QC ID:	QC'd Date::	
Scanner ID:	Scanned Date:	
Acc ID	Acc Date:	

OIITA OIJES OIJKI OIJPO OIJJF V OIJEA OIJEA 0209 OP-OP
 T-(OIITA PASS TO OIJJF)

FROM: 97TH COMBAT BOMB WING 09/0120A D-64-E
 TO : COMBOMBIV. NINE
 409TH BOMB GROUP (INFO)
 410TH BOMB GROUP
 416TH BOMB GROUP
 1ST PATHFINDER PROV. SQ.

D-181

OPERATIONAL PRIORITY BT
 SECRET SENT IN THE CLEAR AUTH: LT. COL. MC AFEE

97TH COMBAT BOMB WING
 APO 140
 09 DEC. 1944.

FIELD ORDER NO. 85-662

MAPS: NORMAL:

1. B. (1) TROOPS WILL BE 3,500 YARDS FROM TARGET.
 (2) 19TH T.A.C. WILL PROVIDE AREA COVER FOR THIS WING.
2. THIS WING WILL ATTACK TARGETS IN GERMANY.

PLAN "A" - ZERO HOUR: INDEFINITE
 PLAN "B" - ZERO HOUR: 09/1000A

PLAN "A"

3. A. 410TH BOMB GROUP
 (12) T.O.T. - ZERO HOUR PLUS 20 MINUTES.
- B. 416TH BOMB GROUP
 (12) T.O.T. - ZERO HOUR PLUS 30 MINUTES.
- X. (1)-(4) NO CHANGE.
 (5) TARGET - SAARWELLINGEN DEFENDED VILLAGE
 (6) A/C REQ - 36 A/C BOMBING BY FLIGHTS OF 6.
 (7) ROUTE OUT - BASE TO 4922N 0610E TO I.P. TO TARGET.
 (8) ROUTE BACK - TARGET TURN LEFT TO R.P. TO BASE.
 (9) ALTITUDE - BOMB AT 12,000 FEET OR BELOW CLOUD BASE, DOWN
 TO BUT NOT BELOW 6,000 FEET. DROP 1,000 FEET AFTER BOMBING.
 (10) I.P. - 4914N 0634E
 (11) AXIS OF ATTACK - GEN. SW TO NE
 (12) M.P..I. - MAP: G.S.G.S. 414, SHEET 6606. ONE FLIGHT ON
 EACH OF THE FOLLOWING GRID COORDINATES: 32228471, 32238448,
 32398427, 32798479, 32708450, 32688430.
 (13) BOMBS - 6 X 500 G.P. FUSED: 1/10 SEC. NOSE, 1/40 SEC. TAIL.
 (416TH GROUP : MINIMUM INTERVALOMETER SETTING).
 (14) R.P. - 4914N 0634E
 (15) NO ALTERNATE TARGETS WILL BE ATTACK.

PLAN "B"

3. A. 410TH BOMB GROUP
 (12) T.O.T. - ZERO HOUR PLUS 25 MINUTES.
- B. 416TH BOMB GROUP
 (12) T.O.T. ZERO HOUR PLUS 40 MINUTES.

- X. (1) - (4) NO CHANGE
- (5) TARGET - SAARWELLINGEN DEFENDED VILLAGE
- (6) A/C REQ - 1ST BOX : 15 A/C, 2ND BOX : 18 A/C WITH ONE PPF A/C.
- (7) RENDEZVOUS - WITH PPF A/C OVER FIELD
- (8) ROUTE OUT - BASE TO 4940N 0612E TO TARGET
- (9) ROUTE BACK - TARGET TURN RIGHT TO BASE.
- (10) ALTITUDE - BOMB AT 13,000 FEET. IN EVENT OF VISUAL BOMBING, MINIMUM ALTITUDE IS 6,000 FEET.
- (11) AXIS OF ATTACK - GEN NW TO SE.
- (12) M.P.I. - MAP G.S.G.S. 4414, SHEET NO.6626 (PPF A/C M.P.I'S : 410TH GROUP - GRID COORD. 323845. 416TH GROUP - GRID. COORD 327846) IN THE EVENT OF VISUAL BOMBING ONE BOX WILL BOMB EACH OF THE FOLLOWING GRID. COORD.32258441 AND 32658446.
- (13) BOMBS - 6 X 500 G.P. FUSED: 1/10 SEC. NOSE, 1/40 SEC. TAIL. (416TH GROUP : MINIMUM INTERVALOMETER SETTING)
- (14) BOMBING WILL BE ON P.P.F. A/C EXCEPT IN CASE OF EQUIPMENT FAILURE IF IT IS NECESSARY TO MAKE A SECOND RUN FOR VISUAL BOMBING, GROUP WILL RETURN TO 4914N 0634E TO BEGIN RUN.
- (15) NO ALTERNATE TARGETS WILL BE ATTACK.
- (16) SECOND BOX WILL FLY BELOW AND TO THE SIGHT OF FIRST BOX.

4. NO CHANGE

5. COMMUNICATIONS

PLAN "A" AND "B"

A. 410TH BOMB GROUP

- (2) GREYGOOSE
- (3) PALLMALL
- (4) RIPSAW

B. 416TH BOMB GROUP

- (2) COURAGE
- (3) PALLMALL
- (4) RIPSAW

COMCBTWIG 97

BT 09/0120A

WCB CES

CC PLAN "A" X. (12) M.P.I. - MAP: G.S.G.S. 4414 RPT 4414

AR

ITA R.....

JKI R.....09/00145A FD AR

JPO R.....09X00 0205A MC AR

JES R.....09/0205A JH AR

ITA R.....

THIS PAGE DECLASSIFIED IAW EO12958

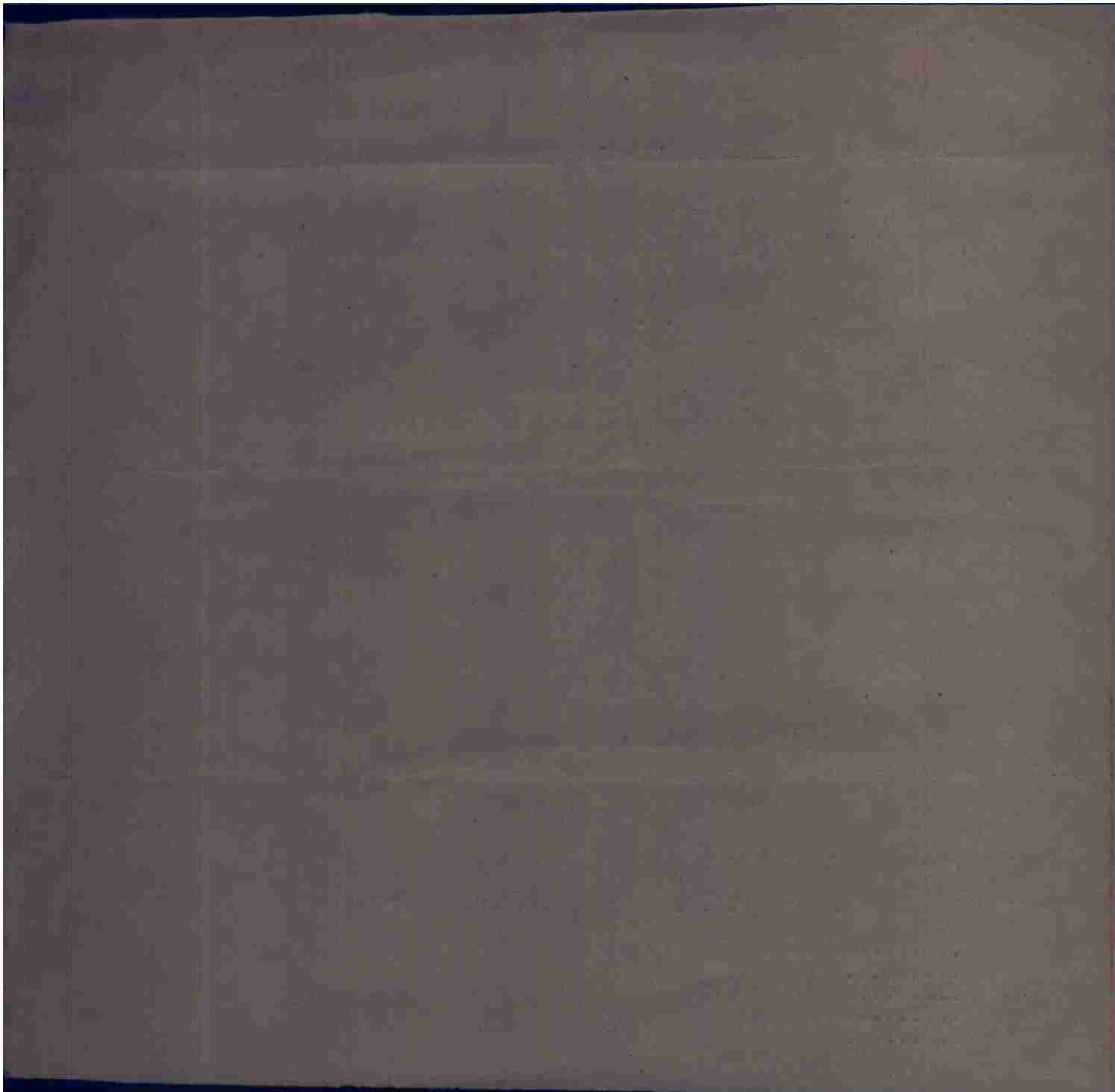

THIS PAGE DECLASSIFIED IAW EO12958

OIITA OIJES OIJPO OIJJI OIJJF V OIJEA
T (OIITA PASS TO OIJJF)

03/09 0P 0P

FROM 97TH COMBAT BOMB WING 09/0845A D-65-E
TO COMBOMDIV IX
COBOMCP 409TH (INFO)
COBOMCP 410TH
COBOMCP 416TH
1ST PATHFINDER SQDN (PROV)

1 53
Rec 18
rec'd by
9 Dec 44
5-2
5-3
5-9

OPERATIONAL PRIORITY BT

SECRET SENT IN THE CLEAR AUTH: LT. COL. MC AFEE

97TH COMBAT BOMB WING
A P O - 140
09 DECEMBER 1944.

ANNEX NO. 1 TO FIELD ORDER NO. 85-662.

PLAN "B" IS IN EFFECT, CANCEL PLAN "A".

COMBOMVIC 97

BT 09/0845A
LEG AR

OIITA R.	09/0955A	DEG	AR	
OIJES R.	09/0955A	WBJ	AR	
OIJPO R.	09/0955A	VAC	AR	KK
OIJJI R.	09/0955A	WFG	AR	

0437 B 9.03
 P 48.44
 1037 C 1.04
 D 3
 1037 C 3470
 1055 E 9.16
 1100 B 9.05
 D 53.20
 11
 71

1464
 1033
 31

1037 C 3470
 1055 E 9.16
 1100 B 9.05
 D 53.20

FLIGHT PLAN

AT 015 0815

STATION *Coast Guard* STAFF END *0844*
 NAME *178* TAXI OUT *0859*
 MISSION *-* TAKE OFF *0914*
 DATE *12/9/44* ON COURSE *0939 (4000)*

COAST IN *1133 1/2* COAST OUT *1032 1/2*
 BASE *1133 1/2* I.P. *1032 1/2*
 REMD. ALT. TARGET *1040*
 LAND FAIL ALT. COAST OUT *1040*
 TARGET ALT. TARGET IN

FROM	POSITION	TO	M. H.	ETA	ATA	TC	DR	TH	VAR	MH	ALL	T. H.	S. I.	S. I.	S. I.	GS	DIST.	TIME	TIME	TIME	REMARKS
<i>Boat</i>	<i>I.P. 0645</i>	<i>71</i>	<i>71</i>	<i>1033</i>	<i>1033</i>	<i>066</i>	<i>-3</i>	<i>063</i>	<i>8</i>	<i>71</i>	<i>1030</i>	<i>190</i>	<i>344</i>	<i>285</i>	<i>116</i>	<i>116</i>	<i>116</i>	<i>29 1/2</i>	<i>12 1/2</i>	<i>43</i>	<i>0932 47.5</i>
<i>I.R.</i>	<i>794 (RT)</i>	<i>142</i>	<i>142</i>	<i>1044</i>	<i>1044</i>	<i>130</i>	<i>+5</i>	<i>135</i>	<i>7</i>	<i>142</i>	<i>1430</i>	<i>225</i>	<i>244</i>	<i>267</i>	<i>344</i>	<i>344</i>	<i>195</i>	<i>53 1/2</i>	<i>195</i>	<i>53 1/2</i>	<i>0956 49.0</i>
<i>Boat</i>	<i>0815</i>	<i>1137</i>	<i>1137</i>	<i>1139</i>	<i>1139</i>	<i>255</i>	<i>+2</i>	<i>257</i>	<i>8</i>	<i>265</i>	<i>200</i>	<i>244</i>	<i>219</i>	<i>219</i>	<i>195</i>	<i>195</i>	<i>195</i>	<i>53 1/2</i>	<i>195</i>	<i>53 1/2</i>	<i>0957 49.5</i>
<i>4914</i>	<i>0834 I.R.</i>	<i>794</i>	<i>52</i>			<i>050</i>	<i>-5</i>	<i>45</i>	<i>7</i>	<i>52</i>	<i>1200</i>	<i>210</i>	<i>247</i>	<i>270</i>	<i>13 1/2</i>	<i>13 1/2</i>	<i>3</i>	<i>3</i>	<i>3</i>	<i>3</i>	<i>1001 32.5</i>
<i>2900</i>	<i>2706</i>	<i>42</i>																			<i>1004 33.0</i>
<i>4000</i>																					<i>1005 33.5</i>
<i>6000</i>	<i>220/25</i>	<i>-5</i>																			<i>1008 34.8</i>
<i>8000</i>																					<i>1010 35.0</i>
<i>10000</i>	<i>270/30</i>	<i>-15</i>																			<i>1015 35.8</i>
<i>12000</i>	<i>270/20</i>	<i>-21</i>																			<i>1028 36.8</i>
<i>15000</i>	<i>270/30</i>	<i>-28</i>																			<i>1047 38.7</i>

REMARKS: *1001 32.5*
1004 33.0
1005 33.5
1008 34.8
1010 35.0
1015 35.8
1028 36.8
1047 38.7

CHALLENGE
 REPLY
 COLORS
 VIEW CHANNEL
 BOMBER C/S
 FIGHTER C/S
 EQUIPER TO BOMBER FREQ.

FLIGHT RECORD

25 min. in down dip

FLIGHT PLAN										ALTITUDE		EPA					
PILOT		NAVIGATOR		MISSION		START END		COAST OUT		COAST IN		ENDING		REMARKS			
WILKINS		ROYALTY		138		0844		10325		1133		AIR SPEED					
PLANE		MISSION		DATE		TAXI OUT		I.T.		REND. ALT.		TIME					
						0849		1040		LAND FAIL. ALT.		RESULTS					
						0939		COAST OUT		TARGET ALT.							
FROM	POSITION	TO	M. H.	ETA	ATM	TC	DR	TH	VAB	NH	ALT	L. ALT.	GS	TO DIST.	TIME	EPA	REMARKS
Base	1944N 06 12E	TARGET	1021	1033	066	-3	63	8	71	192	10000	20000	067	34	295		
		BASE	1034	1040	130	70	135	9	71	192	10000	20000	067	34	295		
		435F	1136	255	48	237	8	265						195	535		
		48 17N 109E	TARGET	050	-5	45	7	052						13 1/2	3		
2000 FT.	270/12	+2															
4000	280/15	-5															
6000																	
8000																	
10000	270/30	-16															
12000	270/30	-21															
HANDS VOUS										LANDING							
COAST OUT		COAST IN		COAST OUT		COAST IN		I.T.		REND. ALT.		LAND FAIL. ALT.					
I.T.		I.T.		I.T.		I.T.											
FLIGHT RECORD										CHALLENGE							
										REPLY							
										COLOURS							
										THE CHANGEL							
										BOMBER C/S							
										FIGHTER C/S							
										EPIPER TO EPIPER PFC.							

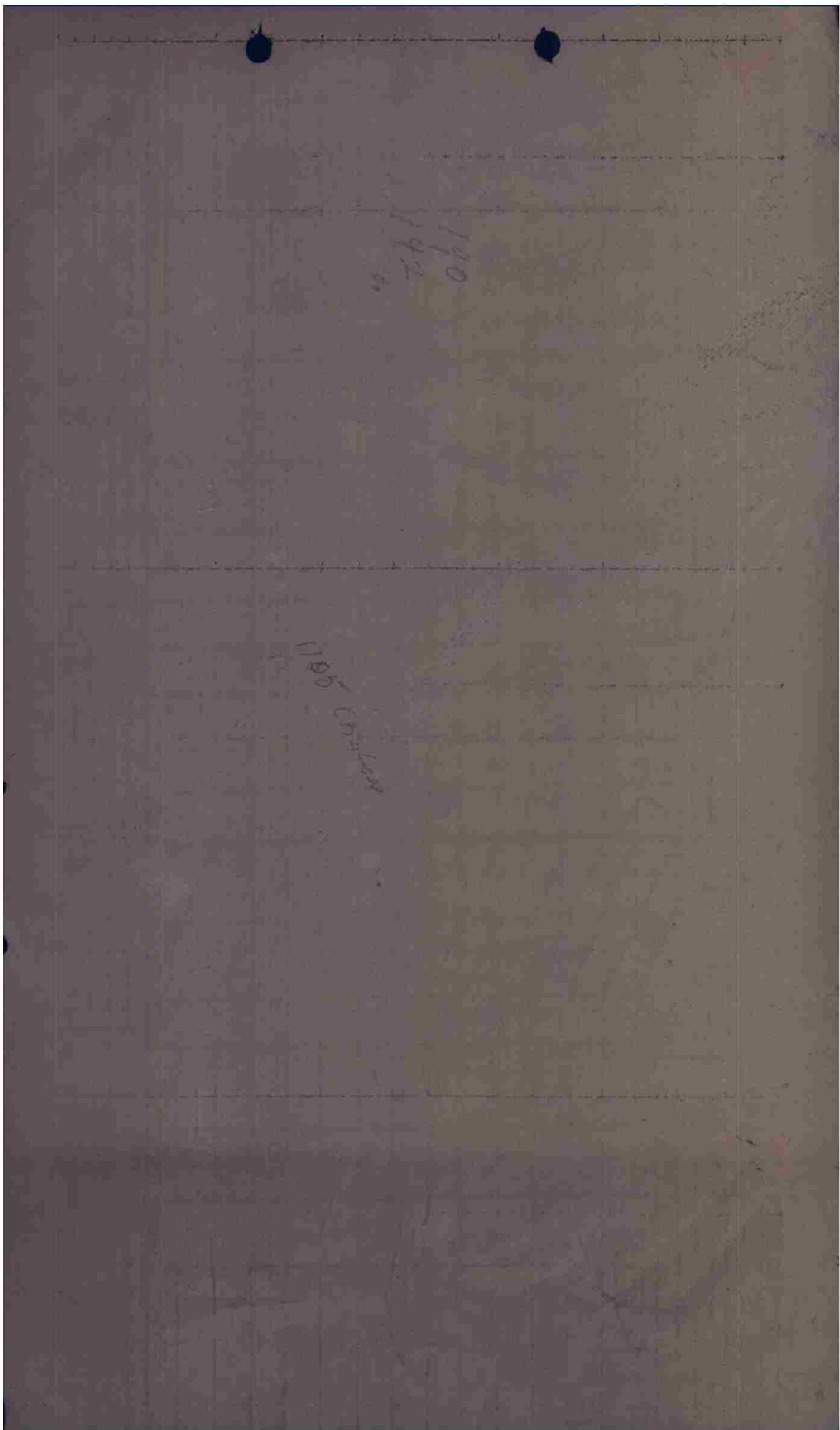

BOMBARDIER'S LOG

12-9-44

DATE

TARGET

Pressure Altitude of Target : <u>484</u>	Type of Release: <input checked="" type="checkbox"/> Train Ind. Slvo.
Altimeter Setting : <u>29.92</u>	Interval : <u>min.</u>
Ind. Alt. : <u>14380</u> True Alt. : <u>13000</u>	Length of Run: _____ Time of Release: _____
Tan. Dropping Angle : <u>.81</u>	Mag. Heading : <u>141°</u>
Disc Speed : <u>179.5</u>	Aircraft Number : _____
Trail <u>59</u> Drift : <u>+5</u>	Pilot : _____
IAS : <u>200</u> TAS : <u>242</u> GS : <u>264</u>	Bombardier-Navigator : _____
<u>6 X 500</u> Nose : <u>1/10</u> Tail : <u>1/100</u>	Box : _____ Flight : _____
Left	Right

Heading	Drift	Tangent	GroundSpeed	Heading	Drift	Tangent	GroundSpeed
131°	+4	.81	265	151°	+5 1/2	.80	260
51°	-4 1/2	.81	264				

Altitude	Disc Speed	Trail	TAS	GS	Tang.	Altitude	Disc Speed	Trail	TAS	GS	Tang.
12000	200	58	246	268	.90						
11000	210.6	58	243	265	.95						
10000	222.5	56	240	262	.97						
9000	236	53	237	259	1.05						
8000	253.5	50	233	252	1.10						
7000	273	49	230	251	1.15						

BOMBARDIER'S LOG

12-9-44
DATE

TARGET

Pressure Altitude of Target : +484	Train Ind. Slvo. <input checked="" type="checkbox"/>
Altimeter Setting : 29.92	Type of Release: <input checked="" type="checkbox"/>
Ind. Alt. : 14380 True Alt. : 13000	Interval : MIN
Tan. Dropping Angle : .81	Length of Run: _____ Time of Release _____
Disc Speed : 179.5	Mag. Heading : 141°
Trail : 59 Drift : +5	Aircraft Number : _____
IAS : 200 TAS : 242 GS : 264	Pilot : _____
CX 500 Nose : 1/0 Tail : 1/00	Bombardier-Navigator : _____
Left	Box : _____ Flight : _____
	Right

Heading	Drift	Tangent	GroundSpeed	Heading	Drift	Tangent	GroundSpeed
131°	+4	.81	265	157°	+5 1/2	.80	260 <small>200 Kts</small>
51°	-4 1/2	.81	264				200 Kts

Altitude	Disc Speed	Trail	TAS	GS	Tang.	Altitude	Disc Speed	Trail	TAS	GS	Tang.
12000	200	58	246	266	.90						
11000	210.6	58	243	265	.95						
10000	222.5	56	240	262	.97						
9000	236	53	237	259	1.05						
8000	253.5	50	233	252	1.10						
7000	273	49	220	251	1.15						

SECRET

11:500:000 EUROPE (AIR)

49°46' 70

COULD BE FLOWN AS BRIEFED
NO FLAK ENCOUNTERED

TARGET

446TH BOMB GP (L)
F.O. # 85-662 9 Dec 1944
TGT. SAARWELLEN (DEFENDED KILLAGE)
ALT. 13,000 To.T. 1040
A/C DISPATCHED 10-AR0 28 A-26
WINDOW CARRIED
WEATHER: 10/10 Cloud

49° 50'

SECRET

168

HEADQUARTERS A16TH BOMB GROUP
Office of the Operations Officer
APO 140, U.S. Army

Date 7 December 1944

SUBJECT: Interrogation of Group Box Leaders on PFF Lead.

TO : CO, 1st. Pathfinder Squadron Prov., APO 140, U.S. Army.

DATE OF MISSION 9 Dec 44 PFF PILOT 1st Lt. McAlvin

GROUP BOX LEADER 1st. Col. D.L. Willette.

1. Was PFF lead entirely satisfactory? If not, why not?

Not entirely. Lead aircraft did not hold constant speed on climb. Was climbing much too slow, and when called by box leader, increased speed too rapidly.

2. Opinion of evasive action taken. None taken.

3. Comment on PFF Navigation. Satisfactory

4. Suggestions. Lead pilots be briefed to make all changes of airspeed gradually, and to use caution that airspeed does not drop so low as to give the formation difficulty.

(OVER)

2ND. BOX

PPF PILOT None GP. BOX LEADER Captain L.A. Herzoff

1. Was PPF lead entirely satisfactory? If not, why not? _____

2. Opinion of evasive action taken. _____

3. Comment on PPF Navigation. _____

4. Suggestions. _____

~~STEWART W. WATSON, Captain, U.S.~~
Asst Operations Officer
~~16th~~ Bomb. Group.

1ST LT JAMES H BOVEN

P-51 A/C # OSP

355 Fighter Sq. 357 Fighter Sq.
STA. F 122 Stephlemorden
on escort with B-17 formation

~~Ret~~ landed at A-55 due to engine trouble. Bad plugs.

OSP returned to base after
(seeing OSP land at 1229)

Returned from SELESTAT (27,500
began cutting out).

up to then no E/A

1400

9 XII 44

SAL

Tp to 9 BC

1410

PILOT HAROLD A/C# 1614 BOX WIN FLIGHT W POS 1

CASUALTIES: _____

BOMB DISPOSITION: PT ST OT JET RET BATTLE DAMAGE: Nil A-C E

FLAK: _____

Nil
No further
turned back at
flurry

E/A: Nil

OBSERVATIONS:

at BL - solid cloud - formation went
into cloud. alt sp out. wanted
jack to take over. Couldn't get
info on box location. Formation
chattered up in cloud. Solid
at 1P.

made turn at abt. 1P.
wouldn't get how post ship
near BL. check formation
log for time - Dd (1033.)

Shriden
Interrogator

PILOT MERCHANT A/C# 560-X BOX WING FLIGHT POS 2

CASUALTIES: _____

BOMB DISPOSITION: PT ST GT JET RET BATTLE DAMAGE: A A-C E

FLAK: _____

*ms Fortie
turned back at
Henry*

E/A: _____

OBSERVATIONS: _____

At 1090 still on course

Interrogator

PILOT JACKSON A/C# 444-J BOXWIND FLIGHT POS 3

CASUALTIES: _____

BOMB DISPOSITION: PT ST OT JET RET BATTLE DAMAGE: A A-C E

FLAK: _____

No further turned back at Stoney

R/A: _____

OBSERVATIONS: _____

*13,000 - layer - at 1020 Hrs.
Weather - leading an Sp out - wanted
back to take formation -
did not.*

*May not have made run,
don't know where turn was
made.*

Interpreter

CONFIDENTIAL

INSTR. FORM

PILOT: Woods A/C# 250 LOK 6 FLIGHT 6 POS 6

CASUALTIES: _____

BOMB DISPOSITION: PT ST CT JET RET 6 BATTLE DAMAGE: A A-C E

FLAM: _____

E/A: _____

OBSERVATIONS: _____

Defeat comb. - with four to 1P
when cloud separated them into
flights. Returned with 3 other ships.
Air Sp. used up.

MBS, _____
Instructor

CONFIDENTIAL
PILOT ROBERTSON A/C# 301-0 BOX 1 FLIGHT 3 POS 2

CASUALTIES: _____

BOMB DISPOSITION: PT ST CF JET RET 500 BATTLE DAMAGE: A A-C E

FLAK: _____

No flak

E/A: _____

OBSERVATIONS: _____

10/10

Perkins

Interrogator

C O N F I D E N T I A L

INTERP. FORM

PILOT SMITH A/C# 271-R BOX 1 FLIGHT 2 POS 3

CASUALTIES: _____

BOMB DISPOSITION: PT ST CT JET RET BATTLE DAMAGE: A A-C E

FLAK: _____

Nil

E/A: _____

OBSERVATIONS: _____

Shard
Interrogator

PILOT MORTON A/C# 178 BOX 1 FLIGHT 1 POS 2

CASUALTIES: _____

BOMB DISPOSITION: PT ST CT JET RET BATTLE DAMAGE: A A-C E

FLAK: _____

E/A: _____

OBSERVATIONS: _____

DP. 1033

TGT. 1040 1/2

B.W. Zenger

PILOT JENKINS A/C# 210-J BOX 1 FLIGHT 1 PCS 3

CASUALTIES: _____

BOMB DISPOSITION: 6 PT ST CT JET RET 300 BATTLE DAMAGE: A A-C E

FLAK: No flak

~~E/A: _____~~

OBSERVATIONS: 10/10

No camera

Perkins

PILOT [K]

CASUALTIES: nil

BOMB DISPOSITION: (PT ST CT JET RET) BATTLE DAMAGE: A A-C E
nil

FLAK: _____

_____ nil

E/A: _____ nil

OBSERVATIONS: _____

Started to ice - 13500

CONFIDENTIAL

Luvia
Interrogator

CONFIDENTIAL

INTOFF. FORM

PILOT MARTIN A/C# 252-D BOX 1 FLIGHT 2 POS 6

CASUALTIES: nil

BOMB DISPOSITION: PT ST CT JET RET BATTLE DAMAGE: A A-C E
nil

FLAK: _____

_____ nil

E/A: _____ nil

OBSERVATIONS: _____

_____ 10/10

Saw Hachley lag and peel off to left at IP.
Nothing appeared wrong with engines.
Did not see Hachley in echelon over field
on return.

Rusia
Investigator

CONFIDENTIAL

INCIDENT FORM

PILOT GREENE A/C# 242-Q BOX 1 FLIGHT 2 POS 4

CASUALTIES: nil

BOMB DISPOSITION: PT ST CT JET RET BATTLE DAMAGE: A A-C E
nil

FLAK: _____

nil

E/A: _____

OBSERVATIONS: Dropped ~~lower~~ though Peck did not
Dropped because everybody else dropped

#5 (Hachley) lagging. Last seen ~~for~~ sure on
bomb run. On way back r A/C lagging but
Hachley not in formation over field.

Ruma

Investigator

CONFIDENTIAL

Interr. Form

PILOT WILKINSON A/C# 106 BOX 1 FLIGHT 1 POS 1

CASUALTIES: nil

BOMB DISPOSITION: (3) (1) BATTLE DAMAGE: A A-C E
nil

FLAK: _____

nil

? Check because
1 indicator light
still on

E/A: _____

nil

OBSERVATIONS: Don't know who else dropped.

10/10 from Chalons - Snowstorm.
GEE^{TOT} OUT

TOT 1040 hr
alt 13800
dir 140° Mag.

Course as briefed

38
1/5

Luvia

CONFIDENTIAL
PILOT VAN ROPE A/C# 233-F BOX FLIGHT 3 POS 5

CASUALTIES:

BOMB DISPOSITION: PT ST GT JET LET 6 BATTLE DAMAGE: A A-C E

FLAK:

Trade didn't drop.

E/A:

OBSERVATIONS:

10/10

Ruvia

Interrogator

CONFIDENTIAL

INSTR. FORM

PILOT VANMETER A/C# 296-D-1 BOX 1 FLIGHT 3 POS 6

CASUALTIES: nil

BOMB DISPOSITION: PT ST CT JET RET BATTLE DAMAGE: A A-C E
6 nil

FLAK: _____

Reader didn't drop
Ⓟ

E/A: nil

OBSERVATIONS: _____

10/10

Interrogator

PILOT NAPIER A/C# 292-H BOX 1 FLIGHT 3 POS 4

CASUALTIES: _____

BOMB DISPOSITION:

PT	ST	CT	JET	RET	A	A-C	E

44 BATTLE DAMAGE: _____

FLAK: nil

E/A: nil

OBSERVATIONS: Turned back when formation
went into overcast -
Did not bomb -

L. P. Ryan
Interrogator

CONFIDENTIAL

INCIDENT FORM

PILOT PECK A/C# 076-9 BOX 1 LIGHT 2 POS 1

CASUALTIES: ~~_____~~

BOMB DISPOSITION: PT ST CT JET RET BATTLE DAMAGE: A A-C E

FLAK: ~~_____~~

E/A: ~~_____~~

OBSERVATIONS: ~~_____~~

B. W. Zeevin
Investigator

PILOT HACKLEY A/C# 244-I BOX 1 FLIGHT 2 POS 5

CASUALTIES: _____

BOMB DISPOSITION: PT ST OT JET RET BATTLE DAMAGE: A A-C E

FLAK: _____

E/A: _____

OBSERVATIONS: _____

James Tomlin
~~ANALYST~~
~~ASST. INT. SEC. STAFF~~
Sandy at 150

Interrogator

PILOT Tolson A/C# 15A EON 2 FLIGHT 1 POS A

CASUALTIES: nil

BOMB DISPOSITION: (PT) SE CT JET RET BATTLE DAMAGE: A A-C E
nil

FLAK: _____

_____ nil

E/A: nil

OBSERVATIONS: _____

_____ 10/10

_____ Rusia

_____ Interrogator

CONFIDENTIAL

CONFIDENTIAL

PILOT Romano A/C# 324 BOX 2 LIGHT 1 POS 3

CASUALTIES: nil

BOMB DISPOSITION: I PT ST CT JET RET BATTLE DAMAGE: nil

FLAK: _____

_____ nil

E/A: _____ nil

OBSERVATIONS: _____

_____ 10/10

Lucia
Interrogator

CONFIDENTIAL

INCIDENT FORM

PILOT Mazoff A/C# 125 BOX 2 FLIGHT 1 POS 1

CASUALTIES: _____

BOMB DISPOSITION: 4 PT ST CT JET RET 500 BATTLE DAMAGE: A A-C E

FLAK: None

E/A: _____

OBSERVATIONS: 10/10

TOT 1041

No camera

Perkins

Interrogator

CONFIDENTIAL
PILOT W. Brady A/C# 230 BOX 2 FLIGHT 2 POS W

CASUALTIES: _____

BOMB DISPOSITION: PT ST CT JET RET 370 BATTLE DAMAGE: A A-C E

FLAK: No flak

~~E/A: _____~~

OBSERVATIONS: 10/10

No camera

Parker
Interpreter

PILOT Brown A/C# 223 BOX _____ FLIGHT 3 POS 7

CASUALTIES: _____

BOMB DISPOSITION: 6 PT ST CT JET RET 500 BATTLE DAMAGE: A A-C E

FLAK: _____

None

E/A: _____

OBSERVATIONS: _____

15/10

Camera took pic.

Perkins

Interrogator

CONFIDENTIAL REPORT FORM

PILOT Tilman A/C# 307 BOX 2 FLIGHT 3 POS 4

CASUALTIES: _____

BOMB DISPOSITION: 6 BT ST CT JET RET BATTLE DAMAGE: nil A A-C E

FLAK: _____

nil

E/A: _____

nil

OBSERVATIONS: _____

Blund
Interrogator

PILOT Anderson A/C# 081 BCX FLIGHT 1 POS 2

CASUALTIES:

BOMB DISPOSITION: 7 PT ST CT JET RET BATTLE DAMAGE: Nil A-C E

FLAK:

Nil

E/A:

Nil

OBSERVATIONS:

Shickel

Indicator

PILOT Evan A/C# 302 BOX 2 FLIGHT 2 POS 4

CASUALTIES: _____

BOMB DISPOSITION: 6 6 6 6 6 BATTLE DAMAGE: nil

FLAK: _____

nil

E/A: _____

nil

OBSERVATIONS: _____

Shirley

Interrogator

CONFIDENTIAL

CONFIDENTIAL

INSUR. FORM

PILOT Buchanan A/C# 019 BOX _____ FLIGHT 2 POS 2

CASUALTIES: _____

BOMB DISPOSITION: 6 PT ST CT JET RET BATTLE DAMAGE: A A-C E

FLAK: _____

me

E/A: me

OBSERVATIONS: _____

[Signature]

MAS

CONFIDENTIAL

INCIDENT FORM

PILOT CONANT A/C# 112 BOX 2 FLIGHT 3 POS 1

CASUALTIES: nil

BOMB DISPOSITION: PT ST GT JET RET BATTLE DAMAGE: A A-C E
nil

FLAK: _____

nil

E/A: _____

OBSERVATIONS: _____

10/10

[Signature]

CONFIDENTIAL

REPORT FORM

PILOT Stanley A/C# 173 BOX 2 FLIGHT 2 POS 1

CASUALTIES:

BOMB DISPOSITION:

PT	ST	CT	JET	RET
3				1

 BATTLE DAMAGE:

A	A-C	E
	hit	

FLAK:

hit

E/A:

hit

OBSERVATIONS:

None

T.O.T. 1042

Shindan

Interrogator

PILOT A/C# BOX FLIGHT POS

CASUALTIES:

BOMB DISPOSITION: PT ST GT JET REF 500 BATTLE DAMAGE: A A-C E

FLAK:

E/A:

OBSERVATIONS:

MAZ
Interrogator

PILOT Mooney A/C# 237 BOX 5 FLIGHT 1 POS 6

CASUALTIES: _____

BOMB DISPOSITION: PT ST CT JET RET 6 BATTLE DAMAGE: A A-C E

FLAK: _____

E/A: _____

OBSERVATIONS:

*lost form in cloud abt 1 P
would have or left out. Came
home with Capt. Moore.*

S

Interrogator

PILOT Tutt A/C# 209 BOX 2 LIGHT 1 POS 5

CASUALTIES: nil

BOMB DISPOSITION: PT ST CT JET RET BATTLE DAMAGE: A A-C B
nil

FLAK: Enemy didn't drop

nil

E/A: nil

OBSERVATIONS:

10/10

Luvia

Interrogator

Box #	OpsFl	Date	F/O	Target	Alt.	Box Leader	T/O	15 min.
		9 Dec 44	85 662	Surrellington (Defended Village)			TOT	
							L/D	
	A/G	Fail to Bomb	ATT	Bomb Issp	A/G Dam	E/A		
	Pos No.	Reason	F S O	P S J F R	M D A A C B E D P D K W M	Perf.		
1	106		4	4				WILLETTS 106 E
2	178		4	4				JOHNNEN MORROW 210-D 178-A
3	210		6	6				PECK 076-Q
1	076		0	0		4		SMITH TRIPP 271-A 241-F
2	241		6	6				
3	271		6	6				
4	242		6	6				
5	244		6	6				
6	252		6	6				STEBELAS 044-E GREENE 242-O
1	034		4	4				
2	301		6	6				DUBOSE ROBERTSON MERTIN HACKLEY 300-F 301-D 252-D 244-T
3	300		6	6				HAPIER 292-H
4	282		0	0				
5	233							
6	296							
614	WINDOWS							LAN METEOR/RIFE 296
060	"							233-H HARROLD WINDOW
444	"							McRonde VACANSON MERCHANT 244

244

606

99

244

TOTALS FOR MISSION

- B.
- (2) No. a/c off by type: _____
 _____ A-20G's _____ A-20J's (obtained from Opns)
- (3) No. of a/c failing to bomb _____ explain each failure.
 Recall due to weather _____
 Personnel _____
 Mechanical _____
 Other Reasons _____
- (4) No. a/c bombing. _____
 _____ Primary.
 _____ Secondary.
 _____ Other.
 (Obtained from recaps.)

- C.
- (1) Time up _____
 T.O.T. _____ (Obtained from Tower).
 Time Down _____

- D.
- (1) No. a/c _____
 _____ Missing _____
 _____ Destroyed _____
 _____ Damaged _____ (cat. B/C)
 _____ Damaged _____ (cat. A)
- (3) No. Crew _____ Killed _____ Wounded _____ Missing _____
 (Obtained from Recaps).

E. Results of Bombing. (Obtained from Group Bombardier).

	No.	Type	
I. Bombs on Primary	_____	X	_____
Bombs on Secondary	_____	X	_____
Bombs on Other	_____	X	_____
Bombs Returned	_____	X	_____
Bombs Jettished	_____	X	_____ Where _____

(Obtained from Recaps)

(The NCO in charge should fill this out immediately finishing taking the recaps and hand to the Officer making up the Ops Report).

JEA ITA V JKI JKI 03/09 OP-OP
T - ITA PASS TO JJF

FROM 416TH BOMB GROUP (L) 09/1350A
TO CG, 9TH BOMB DIV. ATTN: A-2.
CG, 97TH COMBAT WING ATTN: A-2
1ST PATHFINDER PROV. SQ.
CONFIDENTIAL BT

416TH BG D-132-D

OPSFLASH FOR 10 DECEMBER 1944.

P.R.C.

- A. 416TH BG
- B. SAARWELLINGEN
- C. 10 A-20'S AND 28 A-26'S
- D. 27 A/C ATTACKED PRIMARY. THIS OPFLASH DOES NOT COVER PFF A/C
- E. 7 A/C FAILED TO BOMB DUE TO WEATHER. LOST FORMATION IN OVERCAST.
3 A/C CARRIED WINDOW ONLY
BOMBS OF 1 A/C UNACCOUNTED FOR.
- F. 149 X 500 GP ON PRIMARY
41 X 500 GP RETURNED
- G. UNOBSERVED. BOMBING WAS BY PFF TECHNIQUE.
- HN
- H. 1 A/C (NR. 242-Q) UNACCOUNTED FOR. THIS A/C LAST SEEN LAGGING
FORMATION ON BOMB RUN. NO APPARENT ENGINE TROUBLE.
- I. 2 CREW MEMBERS UNACCOUNTED FOR.
- J. NIL
- K. NIL
- L. 13,800
- M. 1040

AYLESWORTH COBOMGR 416

09/1350A
AR. BBBB TO ITA

R.....09/1412A LCB KK
R.....09/1412A AT KKKK

00091982

USAAF FORM 94A

SECRET

SECRET

AUTH: CO STA 2-53

DATE:

INIT:

HEADQUARTERS
416TH BOMBARDMENT GROUP (L)
Office of the Commanding Officer

TO:

From: 416th Bombardment Group (L), APO 140, U.S. Army.

Ref: Oprep A No. 250 for 24 hrs. ending midnight 7 December 1944
Mission or Operation No. 148 97th CGR TO 2 85-642

A. Short Narrative of Operation:

Target Marcellingen (Defended Village)
Place of take-off Station A-3
Place of landing Station A-3
Take-off time 0912 Landing time 1245
Time over target 1040 Bombing Altitude 13,000
Nature of mission Bombing Other None
Weather 10/10's over target area.
Results Observed
Enemy opposition None

B. Type & model of aircraft:

1. Dispatched A-20's and J's - 9
A-20's - 29
2. Attacking target (indicate target) or completing mission.
A-20's and J's - 9 Marcellingen, Defended Village
A-20's - 29 Marcellingen, Defended Village
3. Abortive due to:
 - (1) Weather: 6 - A-20's - 3 - A-20's
 - (2) Personnel: None
 - (3) Mechanical: None
 - (4) Other: None
4. Missing (i.e. cause and place unknown) None
5. Destroyed - before reaching target None
giving cause where known _____
6. Destroyed - over or after leaving None
target giving cause where known _____
7. Damaged (give category & cause) None
8. Sorties A-20's and J's - 6
A-20's - 29

SECRET

(over)

USAF FORM 344 (cont'd)

SECRET

D. Total operational flying hours

a. Day (Sunrise to sunset) A-20's and F's 19:00
A-26's 23:15

b. Night (Sunset to sunrise) None

E. Ammunition by calibres:

a. Total carried into air A-20's and F's 13,500 x .50 Caliber
A-26's 6,000 x .50 Caliber

b. Expended on operations None

c. Lost on wrecked or missing a/c _____

F. Bombs, flares, etc. used:

a. Total carried into air: A-20's and F's - 20 x 500 lb's Bomb 1/100 1/10
A-26's 170 x 500 lb's Bomb 1/10 1/10

b. Expended on operations: A-20's and F's - 20 x 500 lb's
 (List targets separately) A-26's 150 x 500 lb's

c. Jettisoned None

d. Lost or wrecked on missing a/c None

e. Total Returned A-20's and F's - 0
A-26's - 0

G. Own Personnel Casualties:

Type of Casualty	Pilot	Co-pilot	Nav	Bomb	R.Gun	E.Gun	T.Gun
Killed in Action	0	0	0	0	0	0	0
Missing in Action	0	0	0	0	0	0	0
Seriously Wounded	0	0	0	0	0	0	0
Slightly Wounded	0	0	0	0	0	0	0

H. Enemy aircraft by type or description (tentative claims):-

a. Destroyed None

b. Prob. Des None

c. Damaged None

For the Commanding Officer:

GEORGE SCHENKIN,
 Capt in, Air Corps,
 Adjutant.

SECRET

899 99 9.5 8, 0)/
 W R U VTH THIS JEA HAVE ONE FOR YOU AND ANOTHER
 STATION K KKKKKKKK L '09 343 ((

JKI JPO VIA JEA V ITA JJF 3/09 OP - OP

FROM 1ST PATHFINDER SQ 091500A
 TO CG NINTH BOMB DIV
 CG 97TH BOMB WING
 CG 98TH BOMB WING
 CG 99TH BOMB WING
 CO EWWND BOMB GP
 CO 323RD BOMB GP
 CO 344TH BOMB GP
 CO 386TH BOMB GP
 387TH BOMB GP
 CO 391ST BOMB GP
 CO 394TH BOMB GP
 CO 397TH BOMB GP
 CO 410TH BOMB GP
 CO 416TH BOMB GP

OPERATIONAL PRIORITY

1ST PATHFINDER SQ D0102D OPSFLASH REPORT

- A. THREE EIGHT SIX
- B. BAUMHOLDER BARRACKS AREA
- C. 2 B 26
- D. NIL
- E. 2 B26 EATHER
- F. 8 X 500 RETURNED
- G. NONE
- H. NONE
- I. NONE
- J. NONE
- K. NONE
- L. NONE
- M. 1130 21 MILES NORTH ST VITH
 COMMENT: LATE ON RUN DUE TO DETOUR AROUND WEATHER

- A. THREE TWO THREE
- B. AULENBACH
- C. 2 B 26
- D. 1 B 26 PRIMARY ON EQUIPMENT
- E. 1 B 26 EQUIPMENT FAILURE
- F. 4 X 500 PRIMARY 4 X 500 RETURNED
- G. UNOBSERVED
- H. NONE
- I. NONE
- J. NONE
- K. NONE
- L. 14,400 AND 13,120
- M. 1107 AND 1120

COMMENT BOX ONE PFF DROPPED ON EQUIPMENT, BUT DID NOT OBSERVE GROUP TO DROP. BOX TWO PFF WAS KEYED OFF, AND THOUGH FOLLOWING BOX ONE COULD NOT SEE THEIR DROP AND THUS WITHHELD THEIR ATTACK. GROUP SHIPS OF THIS BOX ALSO FAILED TO DROP. WINDOW SHIPS APPROX 500-700 FT ABOVE AND BEHIND PFF A/C

- A. FOUR TENTH
- B. SAARWELLINGEN DEF VIL
- C. ONE B 26
- D. NONE
- E. ONE B 26 EQUIPMENT AND WEATHER
- F. 4 X 500 RETURNED
- G. NONE
- H. NONE
- I. NONE
- J. NONE
- K. NONE
- L. 11/500
- M. 1027

OBSERVATIONS: TWO WING BOMBS REPUTED DROPPED IN FRIENDLY TERRITORY FCOM HIGH FLIGHT, 2ND BOX

- A. THREE FOUR FOUR
- B. BAUMHOLDER BARRACKS AREA
- C. ONE B 26
- D. ONE B 26 PRIMARY ON EQUIPMENT
- E. NONE
- F. 4 X 500 ON PRIMARY
- G. UNOB
- H. NONE
- I. NONE
- J. NONE
- K. NONE
- L. 12, 500
- M. 1121

COMMENT: GROUP DID A GOOD JOB OF FORMATION THROUGH CLOUD-FOLLOWING ERRATIC COURSE AND AIRSPEED WHICH WAS NECESSARY DUE TO WEATHER. GROUP REL ONE BOMB WHEN BOMBAY DOORS OPENED OVER MERZIG

- A. THREE NONE SEVEN
- B. LOSHEIM DEF VIL
- C. ONE B 26
- D. ONE B 26 PRIMARY ON EQUIP
- E. NONE
- K. 4 X 500 ON PRIMARY
- G. UNOB
- H. NONE
- I. NONE
- J. NONE
- K. NONE
- L. 14, 500
- M. 0957 COMMENT GOOD GROUP FORMATION TIGHT FORMATION AT BOMBS AWAY

- A. FOUR SIXTEEN
- B. SAARWELLINGEN DEF VIL
- C. ONE B 26
- D. ONE B 26 PRIMARY ON EQUIP
- E. NONE
- F. 4 X 500 ON PRIMARY
- G. UNOB
- H. NONE
- I. NONE
- J. NONE
- K. NONE
- L. 13, 910
- M. 1040

COMMENT GROUP DID GOOD JOB FORMING

- A. THREE TWO SECOND
- B. SAARWELLINGEN DEF VIL
- C. ONE B 26
- D. NONE
- E. ONE B 26 EX WEATHER
- F. 4 X 500 RETURNED
- G. NONE
- H. NONE
- I. NONE
- J. NONE
- K. NONE
- L. NONE
- M. TURNED BACK AT 1026 30 MILES SHORT OF BOMB LINE

- A. THREE NINE FOUR
- B. OBERTHAT DEF VIL
- C. ONE B 26
- D. ONE B 26 PRIMARY ONE EQUIP
- E. NONE
- F. 4 X 500 PRIMARY
- G. UNOB
- H. NONE
- I. NONE
- J. NONE
- K. NONE
- L. 13, 500
- M. 1005

COMMENT BOMBED WITH ONLY TEN A/C

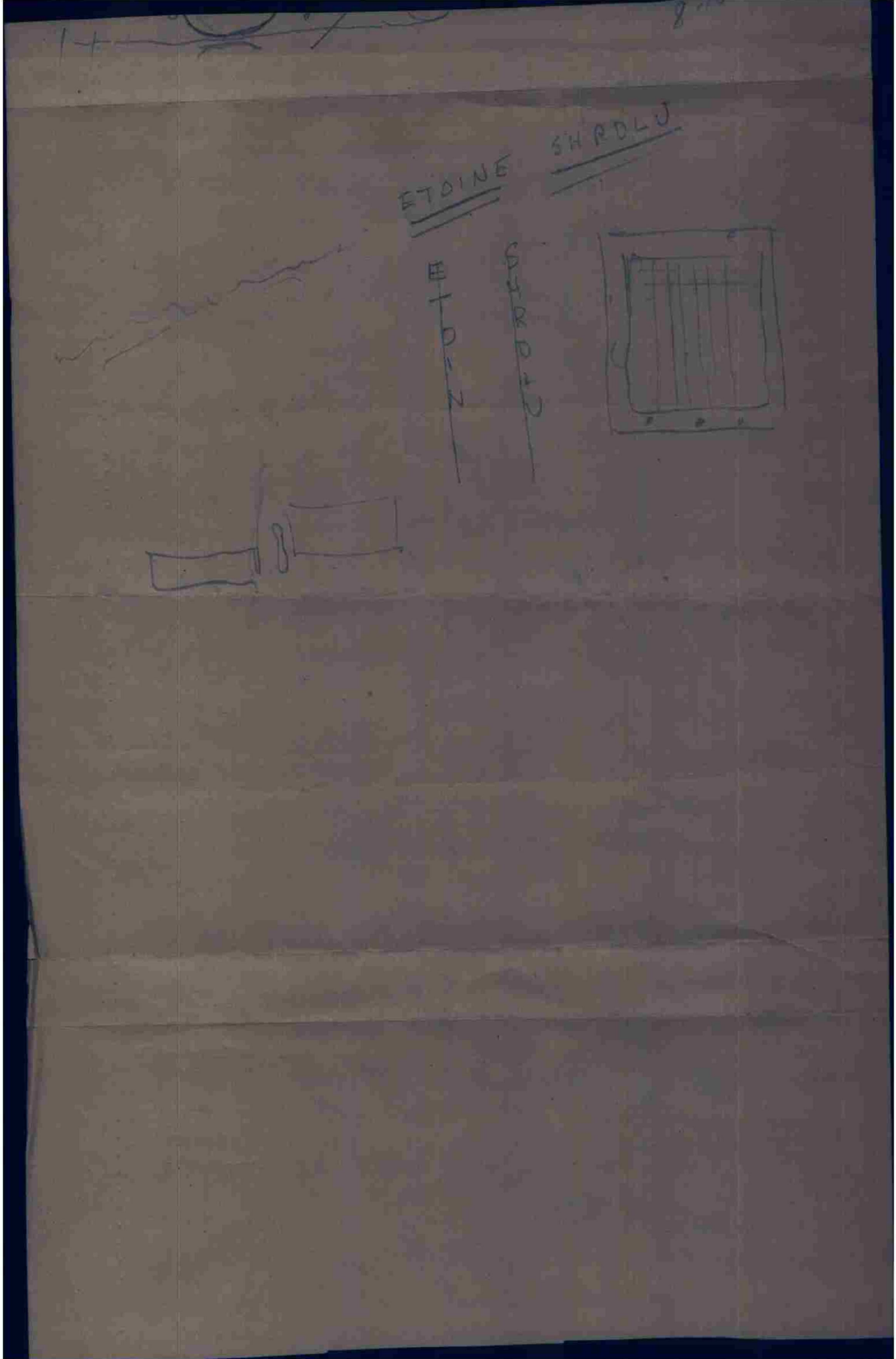

- A. THREE EIGHT SEVEN
- B. LE BAC DEF VIL
- C. ONE B 26
- D. ONE B 26 PRIMARY ON EQUIP
- E. NONE
- F. 4 X 500 ON PRIMAGY
- G. UNOB
- H. NONE
- I. NONE
- J. WEAK INACC HFF MERZIG AREA
- K. NONE
- L. WNW 12,900
- M. 1019

EMMMENYXX
 COMMENT: GROUP DID VERY WELL TO STAY ALONG WITH PFF DISPIE BAD WEATHER CONDITIONS

- A. THREE NINE ONE
- B. BAUMHOLDER BARRACKS AREA
- C. ONE B 26
- D. ONE B 26 PRIMARY ON EQUIP
- E. NONE
- F. 4 X 500 GP ON PRIMARY
- G. UNOB
- H. NONE
- I. NONE
- J. NONE
- K. NONE
- L. 13,700
- M. 1130

COMMENTS: WEATHER VERY BAD. GROUP DESERVES COMMENDATION FOR FOLLOWING

GENERAL COMMENTS: PFF SHIPS CAN ASSURE CLOSER ADHERENCE TO BRIEFED TOT'S IF GROUPS WILL MAKE SURE TO GIVE OVER LEAD IN AMPLE TIME FOR PFK SHIPS TO KILL OR MAKE UP TIME AS DICTATED BY CONDITIONS EXTANT.

CO 1ST PATHFINDER SQ

BT 1500/09
 AS
 CC 1ST PARAGRAPH E. 2 B 26 WEATHER
 AL AR
 AS
 SS (RELAY)
 JKI R.....09:23:00 09/1805A
 JPO R.....09/1805A

WJF B
 KKK B
 R

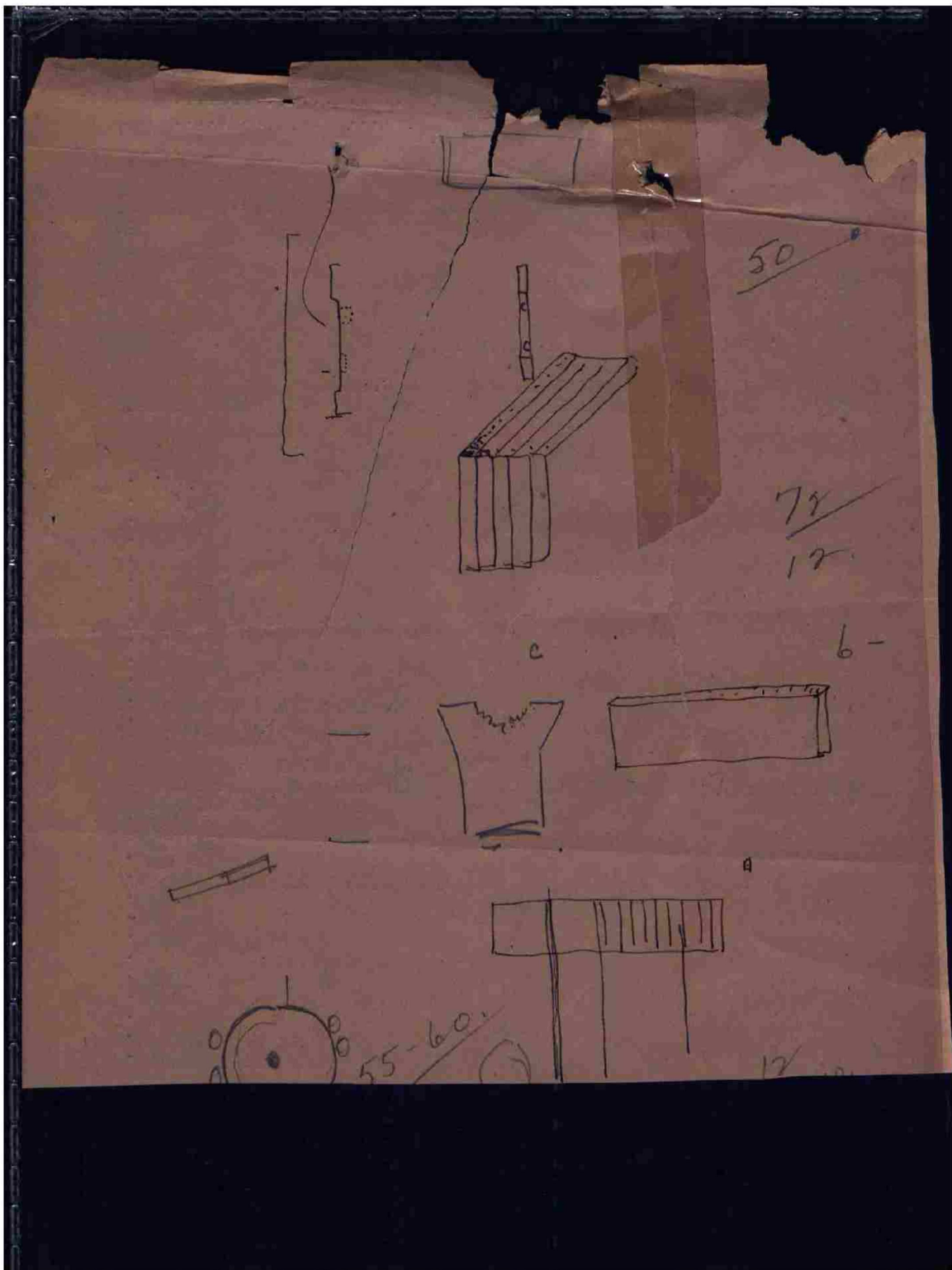

GP-416-50-OP-5
10 Dec 7 1944

AF9
Ship 88-3
Item 2

P.R.C.

SCANNED BY ACD
2007

00091982

DECLASSIFIED
R03 D14 32002 22 Nov 84

MICROFILMED

Recd 2236
3 Dec 44

60

OIITA OIJKI OIJPO V OIJEA OIJE 13/83 (INFO-INFO)

FROM 97TH COMBAT BOMB WING #3/2280A
TO COMBOMDIV NINE
416TH BOMB GROUP
416TH BOMB GROUP
OPERATIONAL PRIORITY BT

ATTN: SIGNAL OFFICER

ADVANCED INFORMATION COPY OF SIGNALS OF FIELD ORDER TO FOLLOW:

5. COMMUNICATIONS

- A. 416TH BOMB GROUP: (PLAN "A" AND "B")
 - (2) MANGO
 - (3) BULLSEYE
 - (4) ROSELEE

- B. 416TH BOMB GROUP: (PLAN "A")
 - (2) BESTMAN
 - (3) JUDITH
 - (4) RIPS AW

X. GENERAL INFORMATION:

(11) BOX LEADERS WILL REPORT TO F.G.C. 2 MINUTES PRIOR TO I.P.

COMBTWIG 97

BT #3/2280A

AR
AS
SS

OIITA R.....#3/2214A NB AR
OIJKI R.....#3/2214A UJF AR
OIJPO R.....#3/2214A DVB AR